

**NECK DETAIL**

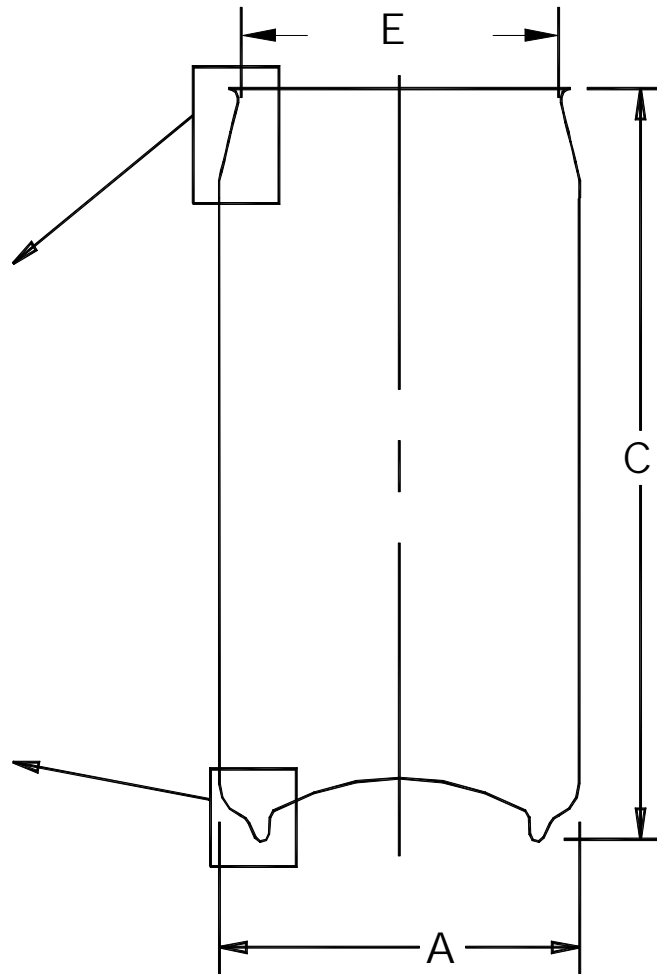
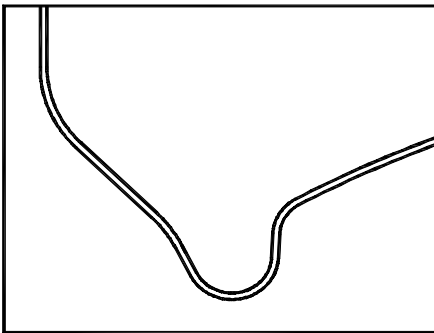

**NECKED & FLANGED CAN**

A	BODY OUTSIDE DIAMETER	(in)	2.600 ± 0.008	
B	FLANGE WIDTH	(in)	0.082 ± 0.010	
C	FLANGED CAN HEIGHT	(in)	6.190 ± 0.015	
D	COLUMN STRENGTH	min	PER CUSTOMER REQUIREMENT	
E	NECK PLUG DIAMETER		2.063 ± 0.007	
F	FILL VOLUME (FL OZ)		<b>BEER / BEV</b>	<b>RETORT</b>
			16.00 ± 0.06	15.00 - 15.25 ± 0.06**
G	FREEBOARD	(in)	0.470 ± 0.020	
H	MATERIAL		H-19 ALUM	
J	DOMES REVERSAL PRESSURE	(PSI)	90 MIN	
K	FLANGE ANGLE		12° MAX	

**\*\*RETORT VOLUMES MAY VARY SLIGHTLY DEPENDING ON PRODUCT, FILL CONTROL CAPABILITIES & LIQUID NITROGEN INJECTION**



METAL BEVERAGE CONTAINER OPERATIONS  
9300 W. 108TH CIRCLE  
WESTMINSTER, CO 80021-3682  
P.O. BOX 589, BROOMFIELD, CO 80038-0589

202/211 X 603 STANDARD  
BEVERAGE/BEER CAN

16 oz  
MANUFACTURING SPECIFICATION

DATE CREATED  
4/17/03

APPROVED  
W Thomas

CREATED BY  
N Zanetell

APPROVED  
B Bass

THE DESIGNS, INFORMATION AND DATA CONTAINED HEREIN ARE PROPRIETARY AND ARE SUBMITTED IN CONFIDENCE, AND SHALL NOT BE DISCLOSED, USED OR DUPLICATED IN WHOLE OR IN PART, FOR ANY PURPOSES WHATSOEVER WITHOUT THE PRIOR WRITTEN PERMISSION OF BALL CORPORATION. RECEIPT OF THIS DOCUMENT SHALL BE DEEMED TO BE AN ACCEPTANCE OF THE CONDITIONS SPECIFIED HEREIN.

PRODUCT STANDARD

CS-A0953

DATE REVISED

REV.

09/01/11

D